

PM type Stepping Motors MSCA series

■ MSCA series



■ Standard specifications

Size (mm)	Φ15 × L10.7	
weight (g)	10.0	
Resistance (Ω)	18	
Rated voltage (V)	5.0	
Driving waveform	Rectangle	
Excitation	2 phase	
Step angle (°)	18.0	
Step accuracy (%)	30	
Holding torque (mN·m)	3.40	
Detent torque (mN·m)	0.27	
Max self start frequency (pps)	1000	
Power supply type	FPC	○
	Lead wire	○
	Pin connector	
Operating temperature (°C)	-10~70	

■ Applications

Information equipment

■ Characteristics

REACH and RoHS compliant

■ Dimensions / Torque characteristic

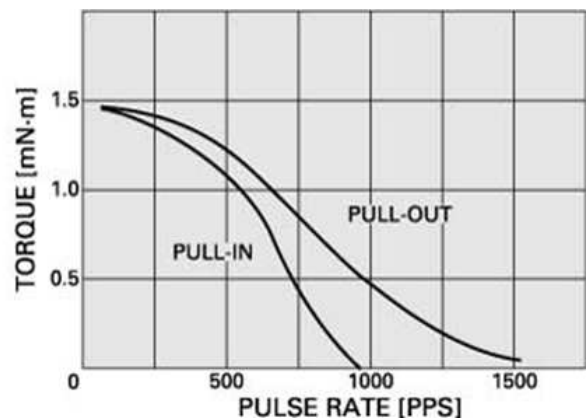
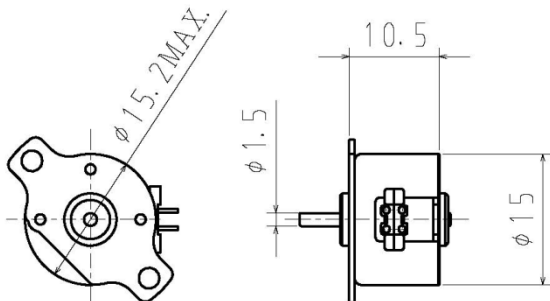

Characteristic data is based on standard specifications

NIDEC SANKYO CORPORATION

For additional information, please contact our sales.

Tokyo Office

Nidec Tokyo Bldg., 1-20-13 Osaki, Shinagawa-ku, Tokyo 141-0032, Japan Tel:(81)3-5740-3000