

PM type Stepping Motors MSGB series

■ MSGB series



■ Applications

Information equipment

■ Characteristics

REACH and RoHS compliant

■ Standard specifications

Size (mm)		Φ25 × L12.2
Weight (g)		28.0
Resistance (Ω)		28
Rated voltage (V)		12
Driving waveform		Rectangle
Excitation		2 phase
Step angle (°)		7.5
Step accuracy (%)		10
Holding torque (mN·m)		25.0
Detent torque (mN·m)		2.6
Max self start frequency (pps)		1100
Lead wire type	FPC	○
	Lead wire	○
	Pin connector	
Operating temperature (°C)		-10~70

■ Dimensions / Torque characteristic

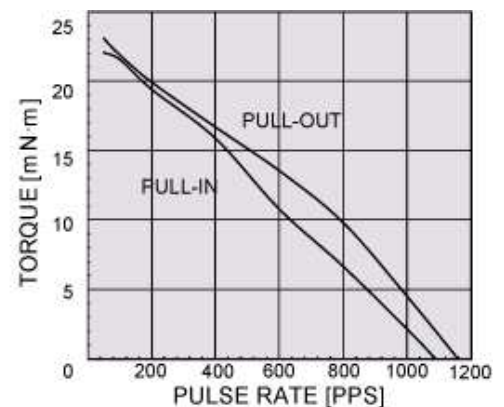
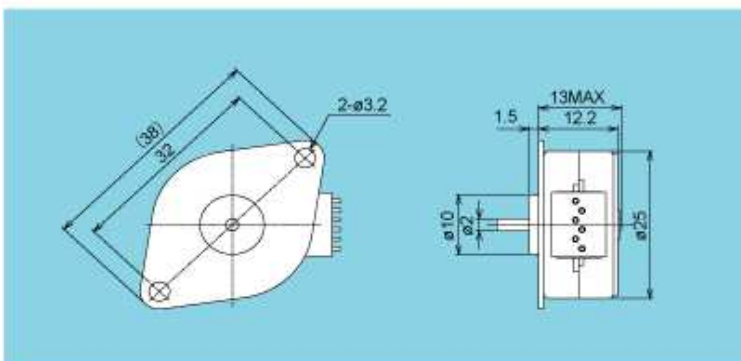

Characteristic data is based on standard specifications

NIDEC SANKYO CORPORATION

For additional information, please contact our sales.

Tokyo Office

Nidec Tokyo Bldg., 1-20-13 Osaki, Shinagawa-ku, Tokyo 141-0032, Japan Tel:(81)3-5740-3000